

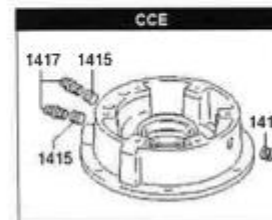

better together

0539.004 - GRN 550/2/G50H A1FT5 NGTAB51040N00NN

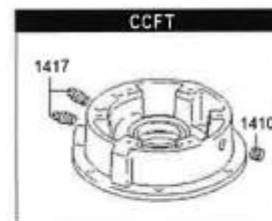

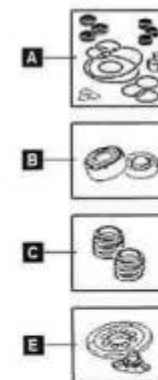
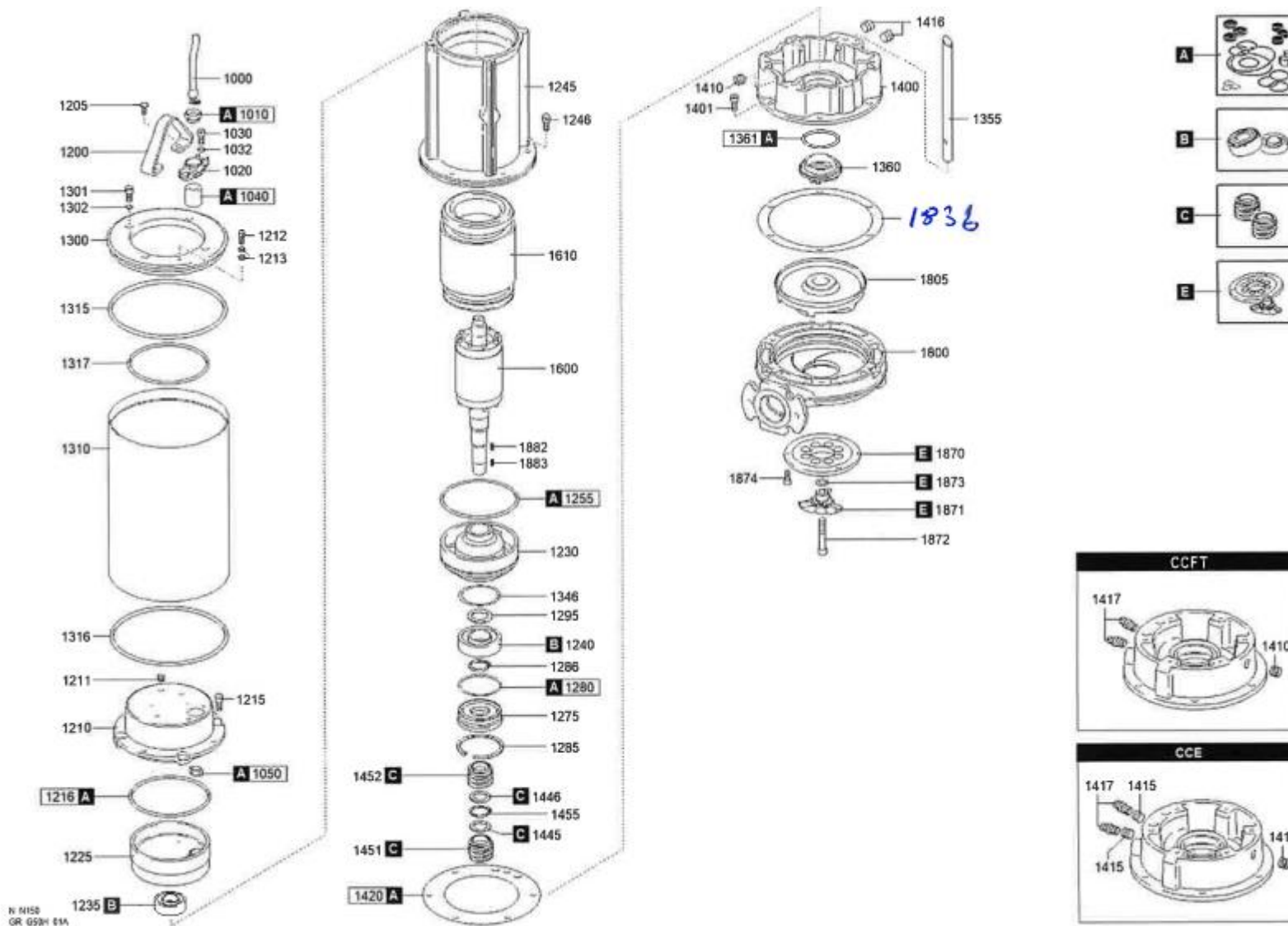

better together



0539.004 - GRN 550/2/G50H A1FT5 NGTAB51040N00NN

	Scanregn Varenummer	Description	Antal
A	5140351000A	GASKETS KIT	1
C	5140342134+35	MECHANICAL SEALS KIT	1
E	5140341116+17	CUTTING SYSTEM KIT	1
B		BEARINGS KIT	1
1000	5140333900	CAVO POTENZA	1
1010	5140331257	RING NUT [POWER CABLE]	1
1020	5140341254	CABLE GLAND [POWER CABLE]	1
1030		SCREW - CABLE GLAND [POWER CABLE]	6
1032		WASHER - CABLE GLAND [POWER CABLE]	2
1040	5140341256	RUBBER GASKET [POWER CABLE]	1
1050		COLLAR CLAMP [POWER CABLE]	1
1200	5140341252	HANDLE	1
1205		SCREW [HANDLE >> COVER]	2
1209		WASHER [HANDLE >> COVER]	2
1210	5140341221	COVER	1
1211		CAP [TIGHTNESS TEST]	1
1213		WASHER [GROUND CABLE]	2
1215		SCREW [COVER >> MOTOR CASE]	4
1216	5140345530	GASKET [COVER >> MOTOR CASE]	1
1225	5140341206	UPPER BEARING HOLDER	1
1230	5140341205	LOWER BEARING HOLDER	1
1235	518063052Z	UPPER BEARING	1
1240	518063072ZC3	LOWER BEARING	1
1245	5140341210	MOTOR CASE	1
1246		SCREW [MOTOR CASE >> OIL CHAMBER]	6
1255	5140345518	GASKET [MOTOR CASE >> LOWER BEARING HOLDER]	1
1275	5140341387	LOWER BEARING FLANGE	1
1280	5140345534	GASKET [LOWER BEARING FLANGE]	1
1285		SEEGER [LOWER BEARING FLANGE >> MECHANICAL SEAL]	1
1286		SEEGER [LOWER BEARING >> LOWER BEARING FLANGE]	1
1295		UPPER DISTANCE RING [LOWER BEARING]	1
1301		SCREW - STOP RING [COOLING JACKET]	6
1346	5140345555	WAVE SPRING	1
1360	5140341386	BUSH [OIL CHAMBER]	1
1361	5140345533	GASKET - BUSH [OIL CHAMBER]	1
1400	5140341385	OIL CHAMBER	1
1401		SCREW [OIL CHAMBER >> PUMP BODY]	6
1410		CAP [OIL CHAMBER]	1

1420	5140341455	GASKET [LOWER BEARING HOLDER >> OIL CHAMBER]	1
1445		WASHER [1st MECHANICAL SEAL]	1
1446		WASHER [2nd MECHANICAL SEAL]	1
1451		1st MECHANICAL SEAL	1
1452		2nd MECHANICAL SEAL	1
1455		SEEGER [1st MECHANICAL SEAL >> 2nd MECHANICAL SEAL]	1
1600	5140351202	SHAFT WITH ROTOR	1
1610	5140353400	WOUND STATOR	1
1800	5140341127	PUMP BODY	1
1805	5140351141	IMPELLER	1
1836	5140341454	GASKET [OIL CHAMBER >> PUMP PLATE]	2
1870	5140341116+17	CUTTING DISK	1
1871	5140341116+17	CHOPPER KNIFE	1
1872		LOCKING CHOPPER KNIFE	1
1873	5140341116+17	WASHER [CHOPPER KNIFE]	3
1874	5140341174	SCREW [CUTTING DISK >> PUMP BODY]	3