

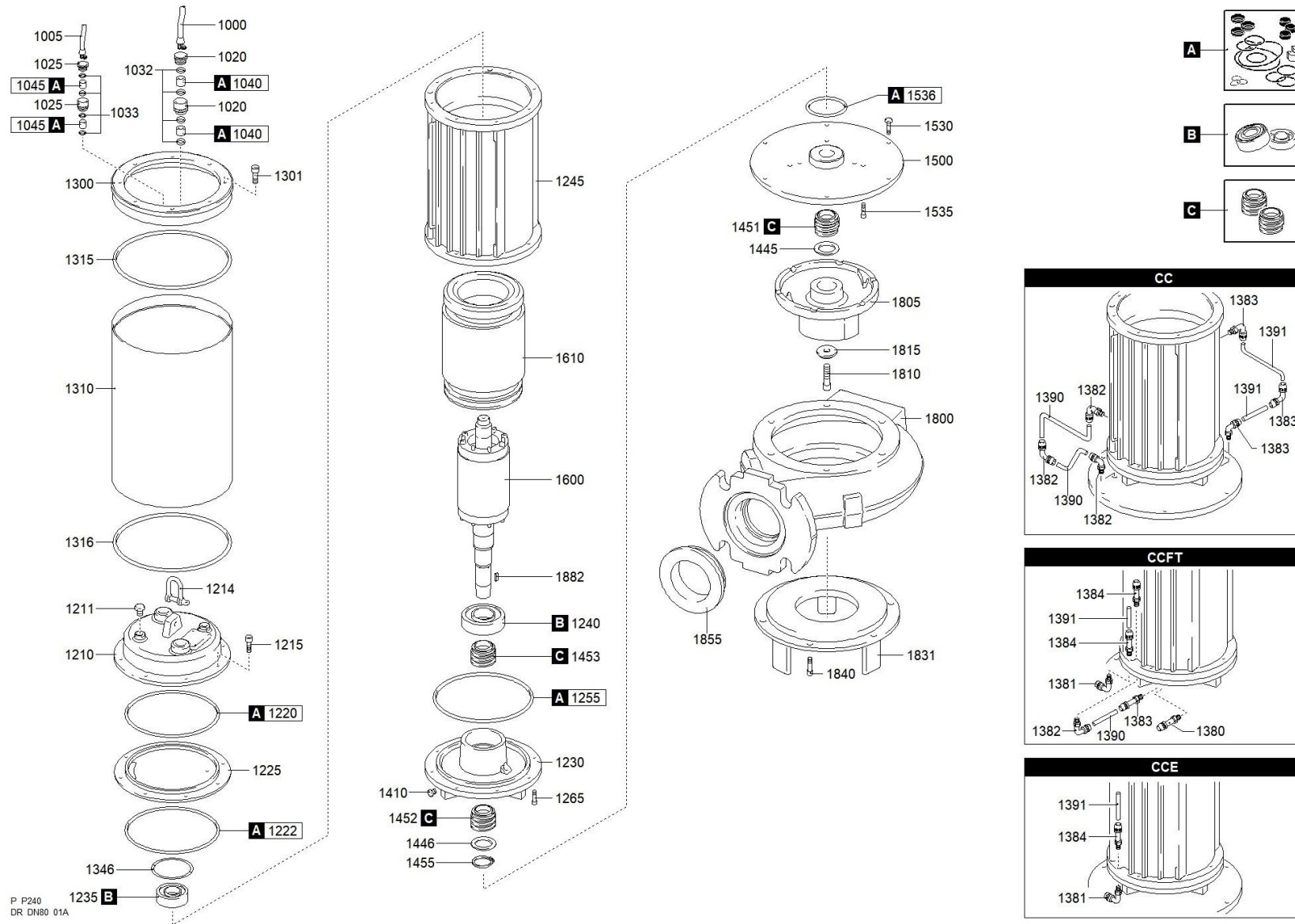

better together

0073.002 - DRP 2000/2/80 A0IT5 NGTAR7104YN00LF





better together



0073.002 - DRP 2000/2/80 A0IT5 NGTAR7104YN00LF

	Scanregn Varenummer	Description	Antal
A		GASKETS KIT	1
C	51406102134+35+36	MECHANICAL SEALS KIT	1
B		BEARINGS KIT	1
1000		CAVO POTENZA	2
1000		CAVO POTENZA	2
1005		SIGNAL CABLE	1
1020	51406051254	CABLE GLAND [POWER CABLE]	2
1020	51406051254	CABLE GLAND [POWER CABLE]	2
1025	51406151261	CABLE GLAND [SIGNAL CABLE]	1
1032	51406055270	WASHER - CABLE GLAND [POWER CABLE]	8
1032	51406055270	WASHER - CABLE GLAND [POWER CABLE]	8
1033	51406035271	WASHER - CABLE GLAND [SIGNAL CABLE]	4
1040	51406051256	RUBBER GASKET [POWER CABLE]	4
1040	51406051256	RUBBER GASKET [POWER CABLE]	4
1045	51406151262	RUBBER GASKET [SIGNAL CABLE]	2
1210	51406151221	COVER	1
1211		CAP [TIGHTNESS TEST]	1
1214	51406051252	D-SHACKLE HOOK	1
1215		SCREW [COVER >> MOTOR CASE]	8
1220	51406085518-S/ET	GASKET [COVER >> UPPER BEARING HOLDER]	1
1222	51406085518-S/ET	GASKET [UPPER BEARING HOLDER >> MOTOR CASE]	1
1225	51406151206	UPPER BEARING HOLDER	1
1230	51406151205	LOWER BEARING HOLDER	1
1235	51806308	UPPER BEARING	1
1240	51803308	LOWER BEARING	1
1245	51406151210	MOTOR CASE	1
1255	51406085518-S/ET	GASKET [MOTOR CASE >> LOWER BEARING HOLDER]	1
1265		SCREW [LOWER BEARING HOLDER >> MOTOR CASE]	8
1410	51406055427	CAP [OIL CHAMBER]	1
1445		WASHER [1st MECHANICAL SEAL]	1
1446		WASHER [2nd MECHANICAL SEAL]	1
1451	51406102134+35+36	1st MECHANICAL SEAL	1
1452	51406102134+35+36	2nd MECHANICAL SEAL	1
1452	51406102134+35+36	2nd MECHANICAL SEAL	1
1453	51406102134+35+36	3th MECHANICAL SEAL	1
1500	51406081362	PUMP PLATE	1
1530		SCREW [PUMP PLATE >> PUMP BODY]	6
1535		SCREW [PUMP PLATE >> LOWER BEARING HOLDER]	3

1536	51406055545	GASKET [PUMP PLATE >> LOWER BEARING HOLDER]	1	
1600	51406081202	SHAFT WITH ROTOR	1	
1610	51406083400	WOUND STATOR	1	
1800	51406081125	PUMP BODY	1	
1805	51406081141	IMPELLER	1	
1810		LOCKING IMPELLER	1	
1815	51406055281	LOCKING WASHER [IMPELLER]	1	
1831	51406081145	SUCTION FLANGE WITH FOOT	1	
1840		SCREW [SUCTION FLANGE >> PUMP BODY]	3	
1855	5140421450N	DISCHARGE GASKET	1	
1882	51406105452	KEY [IMPELLER]	1	