

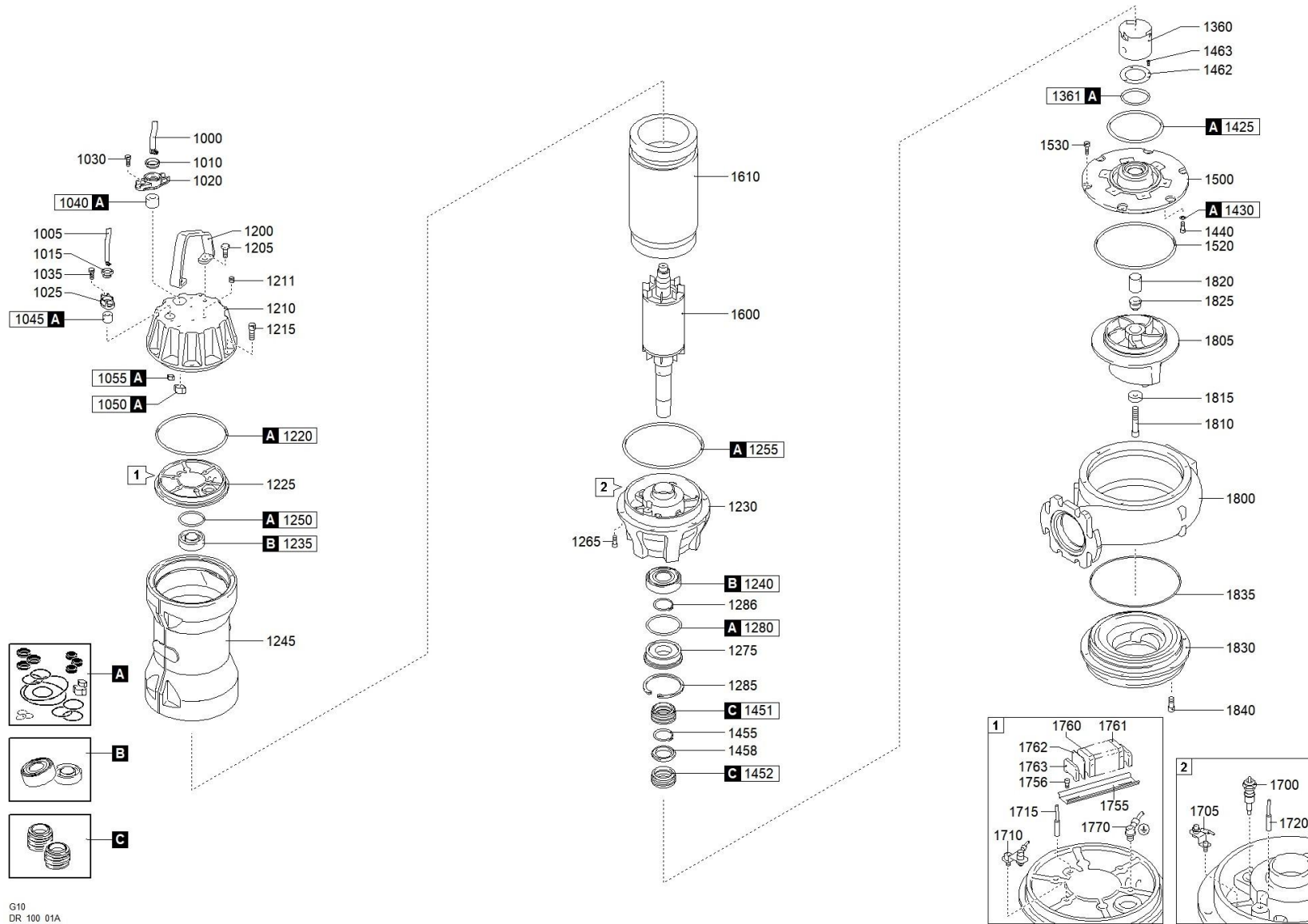

better together

1659.001 - DRG 2000/4/100 A0HT5 NGTSB5104YN00NN





better together



1659.001 - DRG 2000/4/100 A0HT5 NGTSB5104YN00NN

	Scanregn Varenummer	Description	Antal
A	51416293A	GASKETS KIT	1
C	51416330C	MECHANICAL SEALS KIT	1
B		BEARINGS KIT	1
1000		CAVO POTENZA	1
1010		RING NUT [POWER CABLE]	1
1010		RING NUT [POWER CABLE]	1
1015		RING NUT [SIGNAL CABLE]	1
1020		CABLE GLAND [POWER CABLE]	1
1020		CABLE GLAND [POWER CABLE]	1
1030		SCREW - CABLE GLAND [POWER CABLE]	2
1035		SCREW - CABLE GLAND [SIGNAL CABLE]	6
1040		RUBBER GASKET [POWER CABLE]	1
1055		COLLAR CLAMP [SIGNAL CABLE]	1
1200		HANDLE	1
1205		SCREW [HANDLE >> COVER]	2
1210		COVER	1
1211		CAP [TIGHTNESS TEST]	1
1211		CAP [TIGHTNESS TEST]	1
1215		SCREW [COVER >> MOTOR CASE]	6
1220		GASKET [COVER >> UPPER BEARING HOLDER]	1
1225		UPPER BEARING HOLDER	1
1230		LOWER BEARING HOLDER	1
1235	518063062Z	UPPER BEARING	1
1240	51803309	LOWER BEARING	1
1245		MOTOR CASE	1
1250		GASKET [UPPER BEARING]	1
1255		GASKET [MOTOR CASE >> LOWER BEARING HOLDER]	1
1265		SCREW [LOWER BEARING HOLDER >> MOTOR CASE]	6
1275		LOWER BEARING FLANGE	1
1280		GASKET [LOWER BEARING FLANGE]	1
1285		SEEGER [LOWER BEARING FLANGE >> MECHANICAL SEAL]	1
1286		SEEGER [LOWER BEARING >> LOWER BEARING FLANGE]	1
1360		BUSH [OIL CHAMBER]	1
1361		GASKET - BUSH [OIL CHAMBER]	1
1410		CAP [OIL CHAMBER]	1
1425		GASKET [OIL CHAMBER >> PUMP PLATE]	1
1430		GASKET [PUMP PLATE >> OIL CHAMBER]	6
1430		GASKET [PUMP PLATE >> OIL CHAMBER]	1

1440	SCREW [PUMP PLATE >> OIL CHAMBER]	6
1450	MECHANICAL SEAL	1
1451	1st MECHANICAL SEAL	1
1452	2nd MECHANICAL SEAL	1
1455	SEEGER [1st MECHANICAL SEAL >> 2nd MECHANICAL SEAL]	1
1458	DISTANCE RING [1st MECHANICAL SEAL >> 2nd MECHANICAL SEAL]	1
1462	RING [MECHANICAL SEAL]	1
1463	SCREW - RING [MECHANICAL SEAL]	3
1500	PUMP PLATE	1
1520	GASKET [PUMP PLATE >> PUMP BODY]	1
1530	SCREW [PUMP PLATE >> PUMP BODY]	6
1600	SHAFT WITH ROTOR	1
1610	WOUND STATOR	1
1700	HUMIDITY PROBE [OIL CHAMBER]	1
1700	HUMIDITY PROBE [OIL CHAMBER]	1
1755	BRACKET [TERMINAL BOARD]	1
1756	SCREW - BRACKET [TERMINAL BOARD]	2
1756	SCREW - BRACKET [TERMINAL BOARD]	2
1760	POWER CABLE TERMINAL [TERMINAL BOARD]	6
1760	POWER CABLE TERMINAL [TERMINAL BOARD]	6
1761	SIGNAL CABLE TERMINAL [TERMINAL BOARD]	3
1762	TERMINAL CAP [TERMINAL BOARD]	1
1763	TERMINAL LOCKING [TERMINAL BOARD]	2
1770	GROUND CABLE CONNECTOR	1
1770	GROUND CABLE CONNECTOR	1
1770	GROUND CABLE CONNECTOR	1
1800	PUMP BODY	1
1805	IMPELLER	1
1810	LOCKING IMPELLER	1
1815	LOCKING WASHER [IMPELLER]	1
1820	BUSH [IMPELLER]	1
1825	RING NUT [IMPELLER]	1
1830	SUCTION FLANGE	1
1835	GASKET [PUMP BODY >> SUCTION FLANGE]	1
1840	SCREW [SUCTION FLANGE >> PUMP BODY]	6