

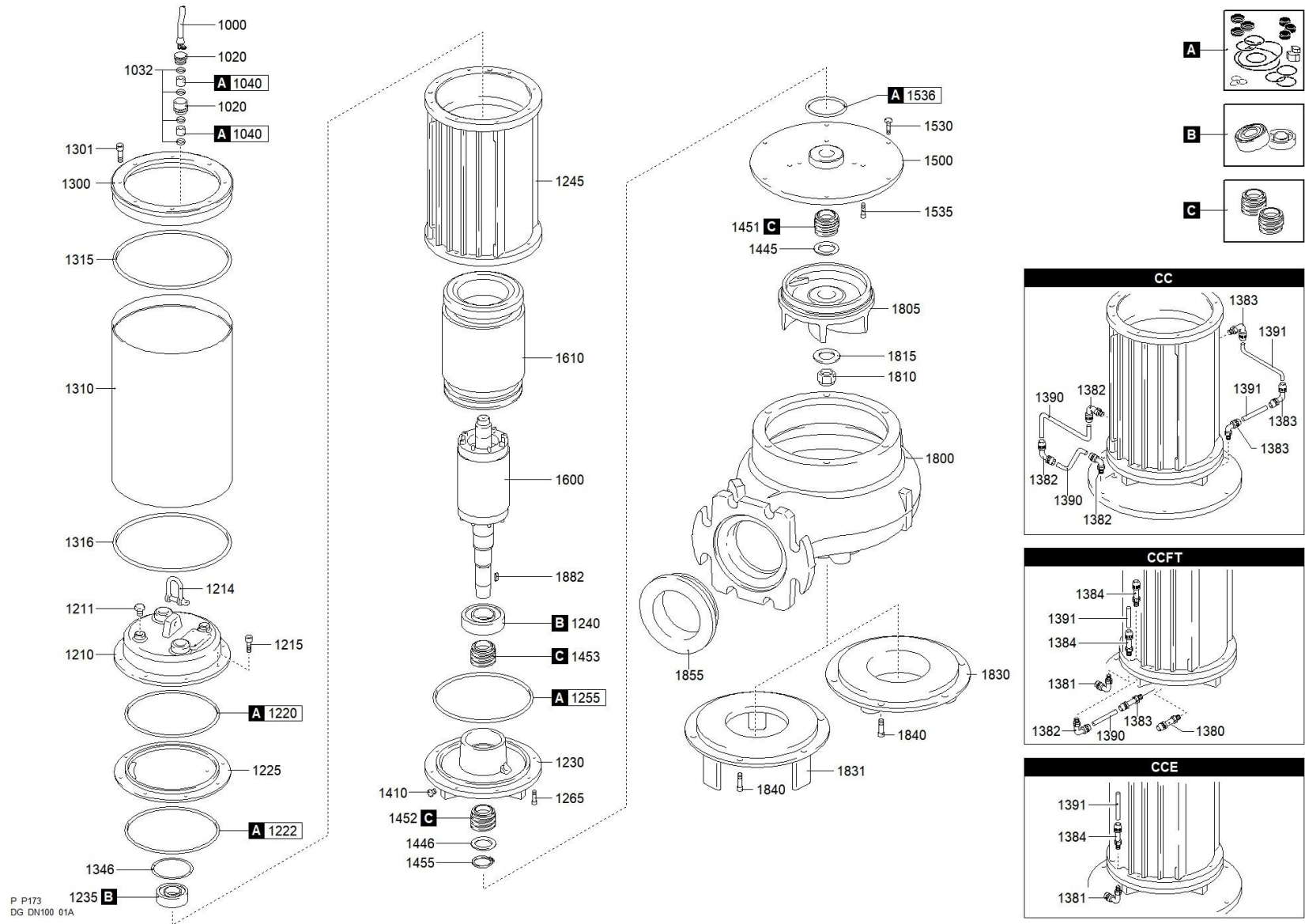

better together

0267.027 - DGP 550/4/100 A0GT5 NGTAR81040S00FA



P P173
DG DN100 01A



better together



0267.027 - DGP 550/4/100 A0GT5 NGTAR81040S00FA

| | Scanregn Varenummer | Description | Antal |
|------|---------------------|---|-------|
| A | 51406051000A | GASKETS KIT | 1 |
| C | 51406052134+35+36 | MECHANICAL SEALS KIT | 1 |
| B | | BEARINGS KIT | 1 |
| 1000 | | CAVO POTENZA | 1 |
| 1020 | | CABLE GLAND [POWER CABLE] | 1 |
| 1032 | | WASHER - CABLE GLAND [POWER CABLE] | 4 |
| 1040 | | RUBBER GASKET [POWER CABLE] | 2 |
| 1210 | 51406051221 | COVER | 1 |
| 1214 | 51406051252 | D-SHACKLE HOOK | 1 |
| 1215 | | SCREW [COVER >> MOTOR CASE] | 4 |
| 1220 | | GASKET [COVER >> UPPER BEARING HOLDER] | 1 |
| 1222 | | GASKET [UPPER BEARING HOLDER >> MOTOR CASE] | 1 |
| 1225 | 51406051206 | UPPER BEARING HOLDER | 1 |
| 1230 | 51406051205 | LOWER BEARING HOLDER | 1 |
| 1235 | 518063052Z | UPPER BEARING | 1 |
| 1240 | 51806306 | LOWER BEARING | 1 |
| 1245 | 51406051210 | MOTOR CASE | 1 |
| 1255 | | GASKET [MOTOR CASE >> LOWER BEARING HOLDER] | 1 |
| 1265 | | SCREW [LOWER BEARING HOLDER >> MOTOR CASE] | 4 |
| 1315 | | UPPER GASKET [EXTERNAL COOLING JACKET] | 1 |
| 1316 | | LOWER GASKET [EXTERNAL COOLING JACKET] | 1 |
| 1346 | | WAVE SPRING | 1 |
| 1410 | | CAP [OIL CHAMBER] | 1 |
| 1410 | | CAP [OIL CHAMBER] | 1 |
| 1445 | | WASHER [1st MECHANICAL SEAL] | 1 |
| 1446 | | WASHER [2nd MECHANICAL SEAL] | 1 |
| 1451 | | 1st MECHANICAL SEAL | 1 |
| 1452 | | 2nd MECHANICAL SEAL | 1 |
| 1453 | | 3th MECHANICAL SEAL | 1 |
| 1455 | | SEEGER [1st MECHANICAL SEAL >> 2nd MECHANICAL SEAL] | 1 |
| 1500 | 51406051362 | PUMP PLATE | 1 |
| 1530 | | SCREW [PUMP PLATE >> PUMP BODY] | 6 |
| 1535 | | SCREW [PUMP PLATE >> LOWER BEARING HOLDER] | 3 |
| 1536 | | GASKET [PUMP PLATE >> LOWER BEARING HOLDER] | 1 |
| 1600 | 51406051202 | SHAFT WITH ROTOR | 1 |
| 1610 | | WOUND STATOR | 1 |
| 1800 | 51406051125 | PUMP BODY | 1 |
| 1805 | 51405051141 | IMPELLER | 1 |

| | | | |
|------|-------------|-------------------------------------|---|
| 1810 | | LOCKING IMPELLER | 1 |
| 1815 | | LOCKING WASHER [IMPELLER] | 1 |
| 1830 | 51406051146 | SUCTION FLANGE | 1 |
| 1840 | | SCREW [SUCTION FLANGE >> PUMP BODY] | 3 |
| 1855 | | DISCHARGE GASKET | 1 |
| 1882 | 51406055452 | KEY [IMPELLER] | 1 |