

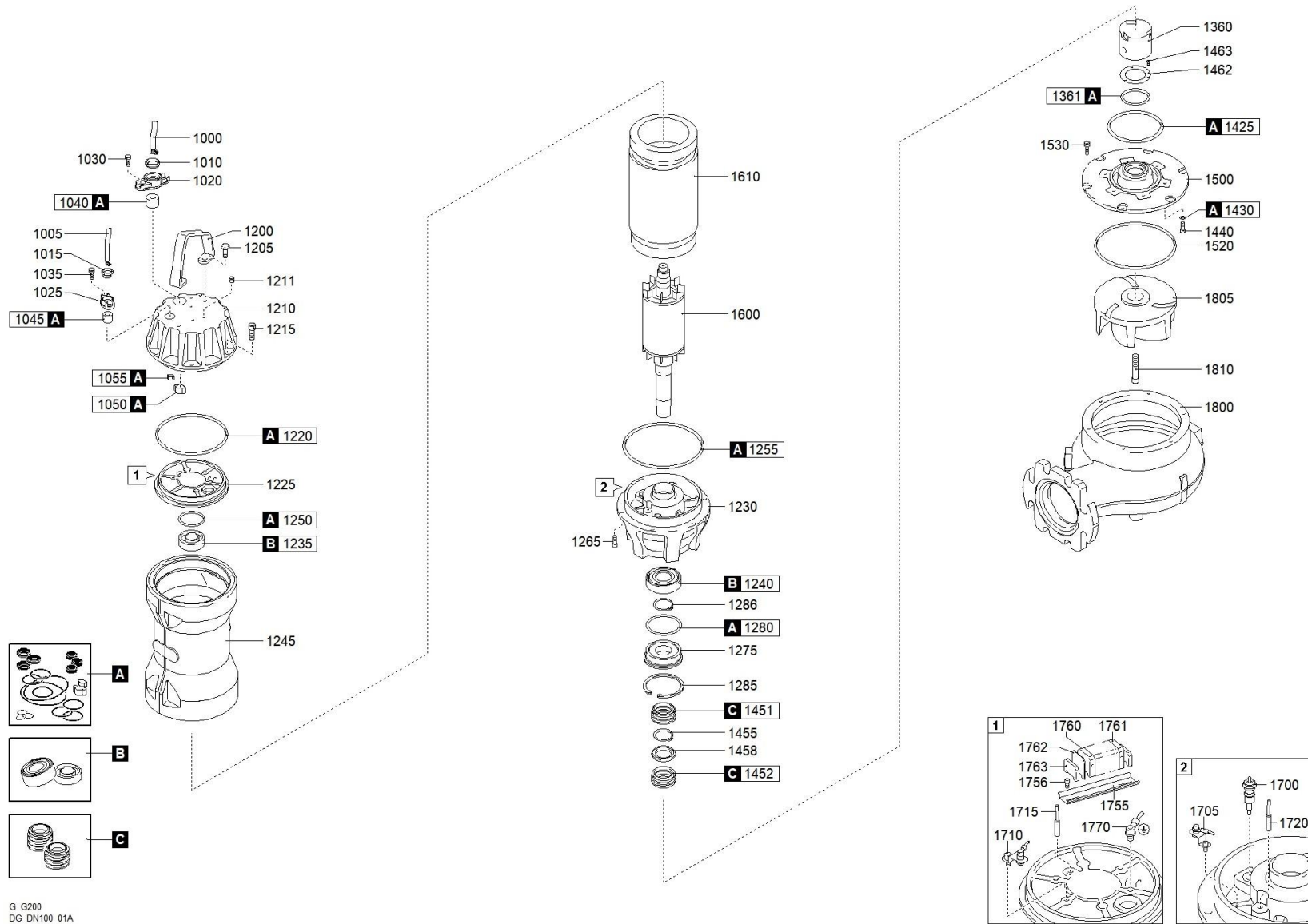

better together

1652.001 - DGG 1500/4/100 B0HT5 NGTSB5104YD00NN



G G200
DG DN100 01A



better together



1652.001 - DGG 1500/4/100 B0HT5 NGTSB5104YD00NN

Scanregn Varenummer	Description	Antal
A 51416293A	GASKETS KIT	1
C 51416330C	MECHANICAL SEALS KIT	1
B	BEARINGS KIT	1
1000	CAVO POTENZA	1
1010	RING NUT [POWER CABLE]	1
1020	CABLE GLAND [POWER CABLE]	1
1030	SCREW - CABLE GLAND [POWER CABLE]	2
1040	RUBBER GASKET [POWER CABLE]	1
1050	COLLAR CLAMP [POWER CABLE]	1
1200	HANDLE	1
1205	SCREW [HANDLE >> COVER]	2
1210	COVER	1
1210	COVER	1
1211	CAP [TIGHTNESS TEST]	1
1211	CAP [TIGHTNESS TEST]	1
1215	SCREW [COVER >> MOTOR CASE]	6
1220	GASKET [COVER >> UPPER BEARING HOLDER]	1
1225	UPPER BEARING HOLDER	1
1230	LOWER BEARING HOLDER	1
1235 518063062Z	UPPER BEARING	1
1240 518063092RS	LOWER BEARING	1
1245	MOTOR CASE	1
1250	GASKET [UPPER BEARING]	1
1255	GASKET [MOTOR CASE >> LOWER BEARING HOLDER]	1
1265	SCREW [LOWER BEARING HOLDER >> MOTOR CASE]	6
1275	LOWER BEARING FLANGE	1
1280	GASKET [LOWER BEARING FLANGE]	1
1285	SEEGER [LOWER BEARING FLANGE >> MECHANICAL SEAL]	1
1286	SEEGER [LOWER BEARING >> LOWER BEARING FLANGE]	1
1360	BUSH [OIL CHAMBER]	1
1361	GASKET - BUSH [OIL CHAMBER]	1
1410	CAP [OIL CHAMBER]	1
1425	GASKET [OIL CHAMBER >> PUMP PLATE]	1
1430	GASKET [PUMP PLATE >> OIL CHAMBER]	6
1430	GASKET [PUMP PLATE >> OIL CHAMBER]	1
1440	SCREW [PUMP PLATE >> OIL CHAMBER]	6
1450	MECHANICAL SEAL	1
1451	1st MECHANICAL SEAL	1

1452	2nd MECHANICAL SEAL	1
1455	SEEGER [1st MECHANICAL SEAL >> 2nd MECHANICAL SEAL]	1
1458	DISTANCE RING [1st MECHANICAL SEAL >> 2nd MECHANICAL SEAL]	1
1462	RING [MECHANICAL SEAL]	1
1463	SCREW - RING [MECHANICAL SEAL]	3
1500	PUMP PLATE	1
1520	GASKET [PUMP PLATE >> PUMP BODY]	1
1530	SCREW [PUMP PLATE >> PUMP BODY]	6
1600	SHAFT WITH ROTOR	1
1610	WOUND STATOR	1
1700	HUMIDITY PROBE [OIL CHAMBER]	1
1700	HUMIDITY PROBE [OIL CHAMBER]	1
1755	BRACKET [TERMINAL BOARD]	1
1756	SCREW - BRACKET [TERMINAL BOARD]	2
1756	SCREW - BRACKET [TERMINAL BOARD]	2
1760	POWER CABLE TERMINAL [TERMINAL BOARD]	6
1761	SIGNAL CABLE TERMINAL [TERMINAL BOARD]	3
1762	TERMINAL CAP [TERMINAL BOARD]	1
1763	TERMINAL LOCKING [TERMINAL BOARD]	2
1770	GROUND CABLE CONNECTOR	1
1770	GROUND CABLE CONNECTOR	1
1770	GROUND CABLE CONNECTOR	1
1800	PUMP BODY	1
1805	IMPELLER	1
1810	LOCKING IMPELLER	1